



TRINOVID

Instruction manual

FOREWORD

Dear Customer,

We wish you a great deal of enjoyment and every success with your new Leica product.

Please read this manual to familiarize yourself with the full scope of functions your product has to offer.

Please use this product only as described in this manual. Only then can safe and easy operation be guaranteed.

Your Leica Camera AG

Please read the chapters “Safety Remarks” and “Important Information” before using the product for the first time. Knowledge of the content will prevent inadvertent damage to the product, possible injuries and other risks.

SCOPE OF DELIVERY

The standard scope of delivery* contains the following:

- Binoculars
- Carry strap
- Eyepiece cover
- Carry case
- Lens cleaning cloth
- Instruction manual
- Test certificate

REPLACEMENT PARTS / ACCESSORIES

Contact Leica Customer Care or your specialist Leica retailer for details on the latest replacement parts / accessory range:

<https://en.leica-camera.com/Stores-Dealers/Leica-dealer-locator>

*The actual scope of delivery may vary depending on model.

LEGAL INFORMATION

LEGAL INFORMATION ABOUT THIS MANUAL

COPYRIGHT

All rights reserved.

All text, images and graphics are subject to copyright and other laws to protect intellectual property. They must not be copied, modified or used for any purpose including trade purposes.

TECHNICAL DATA

Product changes with regards to the product or services may have occurred after the editorial deadline. The manufacturer reserves the right to effect structural or shape changes, color deviations and changes to the scope of delivery or service, where these changes or deviations are reasonably acceptable for the customer, while taking into consideration the interests of Leica Camera AG. In that respect, Leica Camera AG reserves the right to changes and errors. The images in this manual may depict accessory, special features or other items that are not part of the standard scope of delivery or service. Some pages may contain model types and services, which are not offered in specific countries.

BRANDS AND LOGOS

The brand names and logos used in this documented are protected trademarks. These brands or logos must not be used without prior approval by Leica Camera AG.

LICENSE RIGHTS

Leica Camera AG intends to provide you with innovative and informative documentation. Due to the amount of creativity that has gone into its design, we ask for your understanding that Leica Camera AG must protect its intellectual property, including patents, trademarks and copyrights, and that possession of the documentation does not infer any licensing rights of the intellectual property of Leica Camera AG.

REGULATORY INFORMATION

You will find the manufacturing date of your product on the stickers on the packaging. The date format is year/month/day.

SAFETY REMARKS

GENERAL INFORMATION

- Never look directly at the sun or other bright sources of light through your Leica optics! Doing so may seriously damage your eyes.
- Do not use the device while walking. You might trip and fall.
- Keep the device out of the reach of small children.
- This product must not be combined with other optical devices as it would increase the danger of possible eye injuries.

CARRY STRAP

- Once you have attached the carry strap, please make sure that the clips are mounted correctly to prevent the device falling.
- The carry strap is usually made of very robust material. You should therefore keep it out of the reach of children. A carry strap is not a toy and poses a strangulation risk.
- The carry strap should only be used for their intended purpose. Any other use poses the risk of injury and may possibly result in damage to the carry strap and is therefore not permitted.
- Carry straps should also not be used for cameras/binoculars during sports activities that pose a risk of entanglement (e.g. when mountain climbing and similar outdoor activities).

IMPORTANT INFORMATION

GENERAL INFORMATION

- Do not attempt to take the device apart yourself. Repairs must only be carried out in authorized workshops.
- Do not touch the glass surfaces with your fingers, especially if you have previously applied hand cream, insect repellent, etc. These substances may contain chemicals that damage or destroy the coatings on the glass surfaces.
- The device must not come into contact with insect repellent sprays or other aggressive chemicals. Petroleum spirit, thinner and alcohol must not be used for cleaning. Some chemicals and liquids may damage the device housing or its surface coating.
- Always rinse off any traces of salt water! Dried salt crystals could damage the surfaces.
- Make a note of the serial number of your device, as this information will be extremely important in case of loss.

EYEPIECE

- An eyepiece can have the effect of a magnifying glass when exposed to direct frontal sunlight. The device must therefore be protected against extended exposure to direct sunlight. Storing the device in the shade or ideally in its case will help prevent damage to the device interior.

WARRANTY

In addition to your statutory warranty rights from your dealer, Leica Camera AG offers a 10-year warranty for this Leica product in accordance with the conditions started below. The Leica warranty does not impact on any statutory consumer rights in accordance with relevant national law or any consumer rights vis-a-vis the retailer arising from the purchase contract concluded between them.

WARRANTY CONDITIONS

By purchasing this Leica accessory, you have acquired a binoculars that are manufactured in compliance with special quality standards, and which were thoroughly tested at each individual production step by experienced specialists. Our ten-year warranty for this product commences on the date of sale by an authorized retailer under the following conditions:

1. In case of a complaint due to a manufacturing fault, we will assume all material costs during the warranty period. We will additionally cover all required labor costs during the first five years. We shall decide at our own discretion to repair the faulty product, to replace faulty parts or to replace the entire product with a faultless product of the same type. All other claims of any kind and on whatever legal basis shall not be accepted in connection with this warranty.
2. Wear parts like eyecups, leather details, armoring, carry straps and accessories are exempt from the warranty. The same applies for surface damage.
3. Any warranty claims become void if the defect in question is a result of improper handling – which also includes the use of third-party accessories – or if the product was manipulated by unauthorized persons or workshops or if the serial number of the product was rendered illegible.

4. Warranty claims can be submitted only in conjunction with the original proof of purchase – complete with the date of purchase, as well as the address and signature of an authorized retailer.
5. In case of a warranty claim, please send the Leica product, the original proof of purchase and a description of the fault to Leica Camera AG Customer Care or a Leica regional subsidiary.

PICK-UP SERVICE FOR REPAIR SUBMISSIONS

(Applies for EU only)

We will organize the shipping of your device to our Customer Care department if you should notice a problem with your device during the warranty period. Please contact our service hotline to make the necessary arrangements (+49 (0)6441 2080 189). Our pick-up service will collect your Leica product at the agreed time from your premises free of charge and transport it to our Customer Care location for evaluation.

Contact:

en.leica-camera.com/Contact

TABLE OF CONTENTS

FOREWORD.....	2
SCOPE OF DELIVERY	2
REPLACEMENT PARTS / ACCESSORIES	2
LEGAL INFORMATION.....	3
SAFETY REMARKS	4
IMPORTANT INFORMATION.....	4
WARRANTY.....	5
PART DESIGNATIONS	7
PREPARATION	8
ATTACHING THE CARRY STRAP	8
SETTING THE EYECUPS.....	8
DIOPTR SETTINGS.....	9
SETTING THE INTEROCULAR DISTANCE.....	9
SETTINGS AND OPERATION	10
SETTING THE IMAGE SHARPNESS	10
FAQ	11
CARE/CLEANING	12
TECHNICAL DATA	12
LEICA CUSTOMER CARE.....	13

Definition of the various categories of information found in this manual

Note

- Additional information

Important

- Non-compliance may result in damage to the device and accessories

Attention

- Non-compliance may result in personal injury

PART DESIGNATIONS

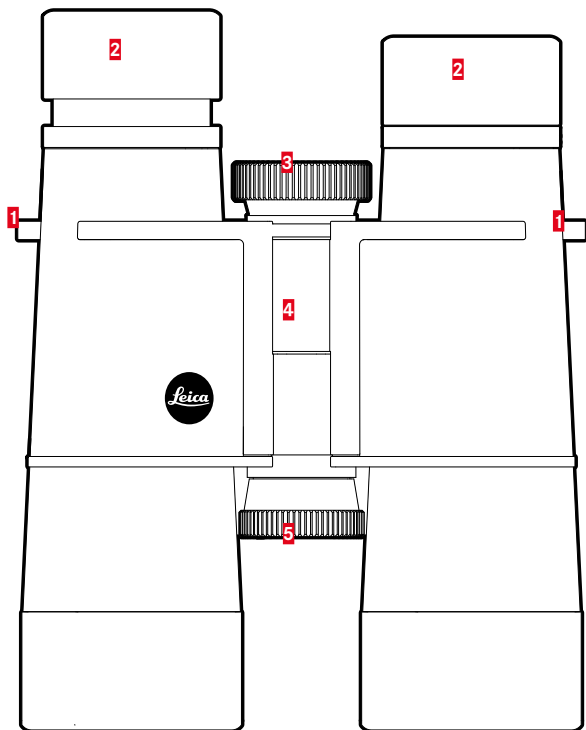

- 1** Strap lugs
- 2** Eyecup
- 3** Focusing wheel
- 4** Center hinge
- 5** Diopter compensation

Attention

Never look directly at the sun or other bright sources of light through your Leica optics! Doing so may seriously damage your eyes.

PREPARATION

ATTACHING THE CARRY STRAP

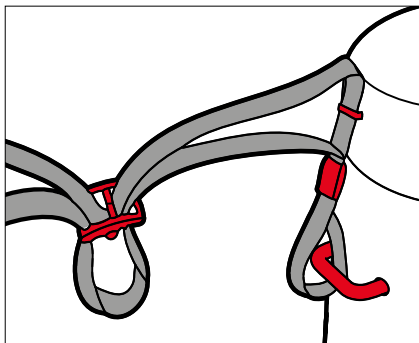

The eyepiece caps can be attached to the carry strap, at the same time as the carry strap is attached to the binoculars.

- ▶ Attach and tighten the carry strap as shown in the illustration

Important

- Check the correct attachment of the carry strap by pulling at it with some force. The length of the carry strap must not change.

SETTING THE EYECUPS

The position of the eyecups will depend on whether you will be using your binoculars with or without eyeglasses. Contact lens wearers can make the settings just like anyone not wearing any eyeglasses.

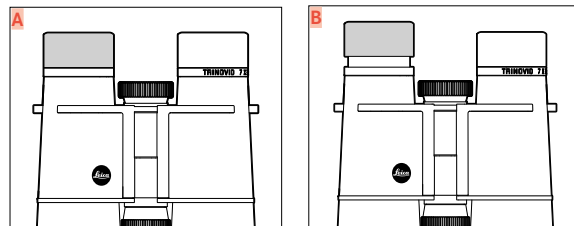

FOR USE WITHOUT EYE GLASSES

- ▶ Pull out the eyecup half way or fully (Fig. A)

FOR USE WITH EYE GLASSES

- ▶ Push the eyecup in fully (Fig. B)

DIOPTR SETTINGS

A diopter compensation function for up to ± 3 diopter is available to allow wearers of glasses the use of this product without eye glasses.

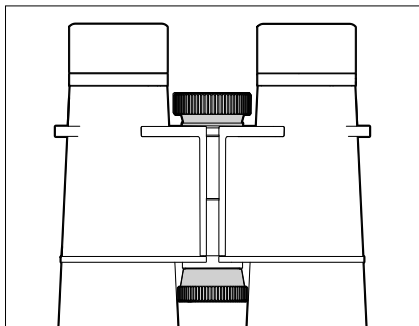

- ▶ Close your right eye or cover the right-hand lens
- ▶ Adjust the focusing wheel so that you can see the target object with optimum focus through the left-hand binocular tube
- ▶ Close your left eye or cover the left-hand lens
- ▶ Adjust the diopter compensation until the same object appears with optimum focus through the right-hand binocular tube as well

SETTING THE INTEROCULAR DISTANCE

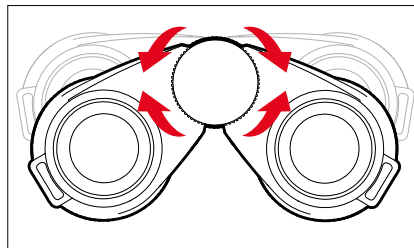

Adjust the interocular distance by moving the hinged joint to match your personal requirements. When the interocular distance is set correctly, the right and left fields of view merge into a circular image.

- ▶ Move the two halves of the binoculars via the central joint until no distracting shadows remain in your view

SETTINGS AND OPERATION

SETTING THE IMAGE SHARPNESS

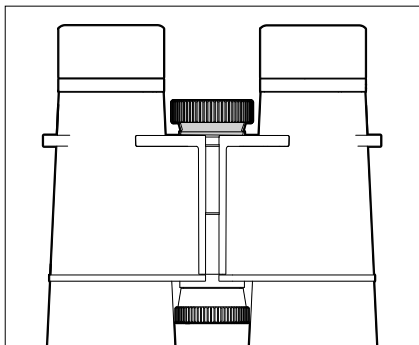

- ▶ Look through the binoculars
- ▶ Aim at the target object
- ▶ Adjust the focusing wheel until you can see the target object with optimum sharpness

Problem	possible cause to be verified	Troubleshooting suggestions
The image is not perfectly circular	The binoculars are not adjusted correctly to your personal interocular distance.	Move the two halves of the binoculars via the central joint until you have corrected the setting.
	Your pupils are not in line with the exit pupils of the binoculars.	Try adjusting the position of your head or eyes in conjunction with the position of the binocular tubes.
	The positioning of the eyecups does not reflect the optimal distance between eye and eyepiece for best possible eye relief.	Adjust the eyecup position for observations with/without eyeglasses.
	The positions of the left and right eyecup differ.	Move both eyecups into the same position.
The image is out of focus	The diopter compensations are incorrect.	Re-adjust the diopter and focus settings.
	The positioning of the eyecups does not reflect the optimal distance between eye and eyepiece for best possible eye relief.	Adjust the eyecup position for observations with/without eyeglasses.
	The positions of the left and right eyecup differ.	Move both eyecups into the same position.
	The diopter setting at infinity is still insufficient.	Wear eyeglasses or contact lenses when using the binoculars.
There are dark or kidney shaped shadows in the image	The binoculars are not adjusted correctly to your personal interocular distance.	Move the two halves of the binoculars via the central joint until you have corrected the setting.
	The positioning of the eyecups does not reflect the optimal distance between eye and eyepiece for best possible eye relief.	Adjust the eyecup position for observations with/without eyeglasses.
	The positions of the left and right eyecup differ.	Move both eyecups into the same position.

CARE/CLEANING

- Your Leica product requires no special care.
- Coarse dirt particles like sand can be removed with a soft brush or simply blown off.
- Fingerprints, etc. on front lenses and eyepiece lenses can be pre-cleaned with a damp cloth and then wiped dry with a clean leather or lint-free cloth.
- Do not use alcohol or chemical cleaning solutions on the optics or housing.
- Do not use excessive force when cleaning a severely soiled lens surface. The coating is abrasion resistant, but not impervious to sand or salt crystals.
- The housing should be cleaned using a damp leather cloth only. Using a dry cloth may cause friction, which may result in a static discharge.
- Always rinse off any traces of salt water! Dried salt crystals could damage the surfaces.
- The device should be stored in a well-ventilated, dry and cool place to prevent fungal growth (particularly important in humid climates).

TECHNICAL DATA

Please visit the Leica Camera AG homepage for more information about the technical details of your Leica binoculars:

<https://en.leica-camera.com/Sport-Optics/Hunting/Binoculars/Leica-Trinovid-HD>

LEICA CUSTOMER CARE

Please contact the Customer Care department of Leica Camera AG for the maintenance of your Leica equipment and for help and advice regarding Leica products and how to order them. You can also contact the Customer Care department or the repair service provided by your regional Leica subsidiary for repairs or warranty claims.

Leica Camera AG
Leica Customer Care
Am Leitz-Park 5
35578 Wetzlar
Germany

Phone: +49 (0)6441 2080-189

Fax: +49 (0)6441 2080-339

Email: customer.care@leica-camera.com

www.leica-camera.com