

LEICA M6

QUICK START GUIDE

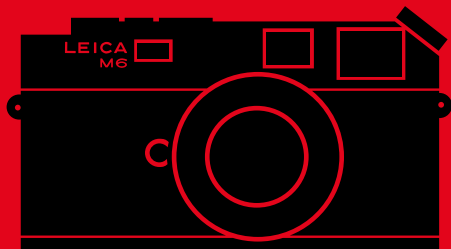

PART DESIGNATIONS

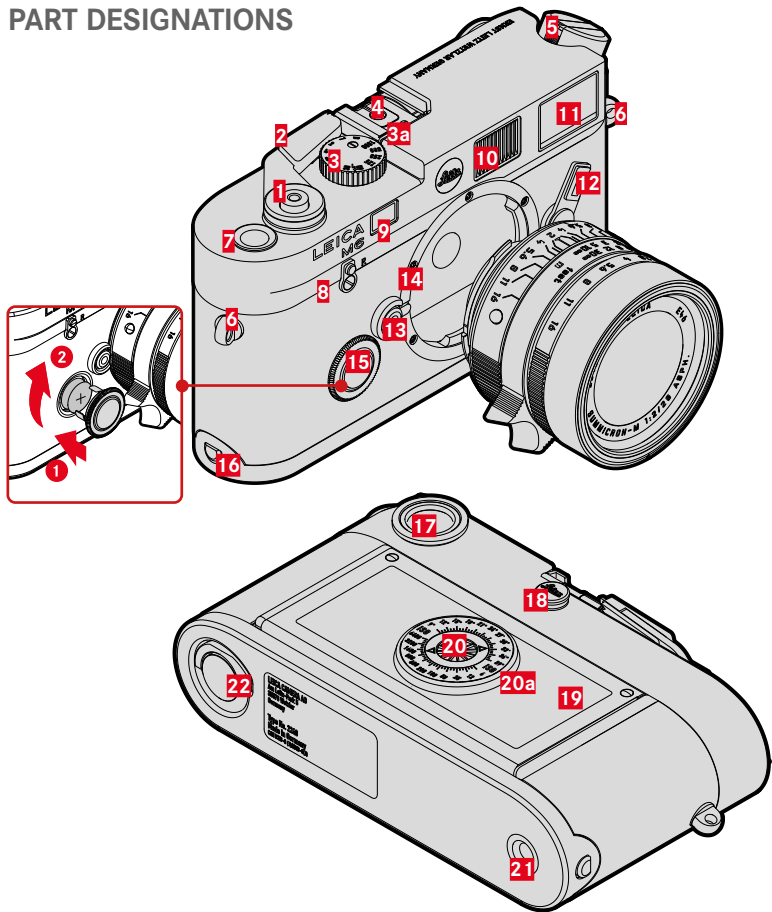

1 Shutter button

Tap:

- Activating exposure metering

Press down fully:

- Shutter release

2 Film advance lever

3 Shutter speed dial with stop positions

- **1s** - **1000**: Shutter speeds
- **B**: Long-term exposure, deactivation of camera electronics
- **⚡**: 1/50s, slower shutter speeds available

a Index

4 Accessory shoe

5 Fold-out rewind crank

6 Strap lugs

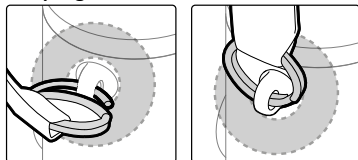

7 Exposure counter

8 Rewind locking lever

9 Rangefinder window

10 Illuminating window for bright-line frame

11 Viewfinder window

12 Image field selector

Selection of bright-line frame pairs
35/135 mm, 50/75 mm and 28/90 mm

13 Lens release button

14 Bayonet

15 Battery compartment with cover



2x silver oxide button cell

(**PX76 SR44**)

or

1x Lithium battery (**DL1/3N**)

16 Bottom cover locking point

17 Viewfinder eyepiece

18 Contact jack for flash units with cable connection

19 Rear cover (hinged)

20 ISO focusing screen

6 - 6400: Fixed ISO values

a Index

21 Tripod thread A 1/4, DIN 4503 (1/4")

22 Locking toggle for bottom cover

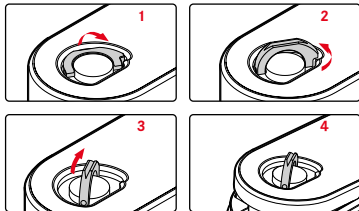

DISPLAYS IN THE VIEWFINDER

The bright-line rangefinder in this camera is more than just a very bright viewfinder – it also is a lens-coupled rangefinder. All Leica M lenses with focal lengths between 16 and 135 mm are coupled automatically.

35 mm/135 mm



28 mm/90 mm

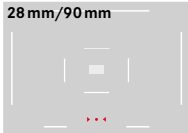

- A** Bright-line frame
- B** Metering field for focusing
- C** Light balance

50 mm/75 mm

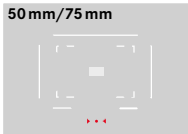

INSERTING THE FILM PACK

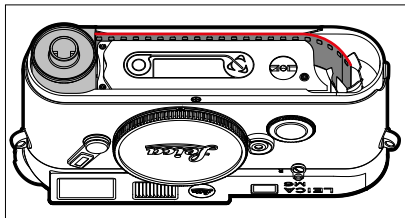

REWINDING THE FILM PACK

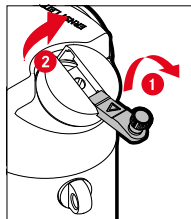
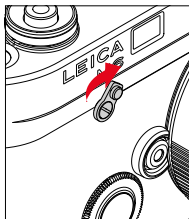

REPLACING THE FILM PACK

OPENING THE CAMERA

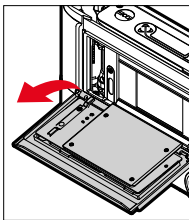
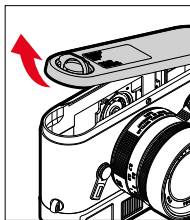

REMOVING THE FILM PACK

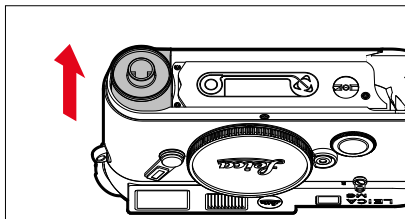

FOCUSING

SUPERIMPOSED IMAGE METHOD (DOUBLE IMAGE)

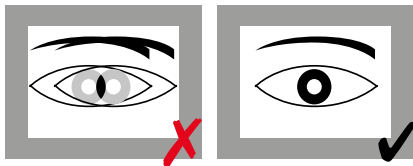

SPLIT IMAGE METHOD



TECHNICAL DATA

CAMERA

Designation

Leica M6

Camera type

Analogue rangefinder system camera (35 mm)

Type No.

2248

Order No.

10 557

Material

Closed full metal housing

Top cover and bottom cover: brass, black finish

Lens mount

Leica M bayonet

Operating conditions

0°C to +40°C

Weight

575 g (without battery)

VIEWFINDER

Viewfinder

Large, bright-line rangefinder with automatic parallax compensation

SHUTTER

Shutter type

Focal plane shutter with rubber liner, mechanically controlled

Shutter speeds

Mech. shutter: 1 s - 1/1000s

Flash Synch: up to 1/50s

FOCUSING

Working range

70 cm to ∞

POWER SUPPLY

2 Silver oxide button cells (PX76/SR44) or 1 Lithium battery (DL1/3N)

The production date of your camera is printed on the packaging. The date format is year/month/day. Subject to changes in design and model type.

SAFETY REMARKS

GENERAL INFORMATION

- As a general rule, store your small parts as follows:
 - out of the reach of children
 - in a safe location, where they will not get lost or stolen
- Only use accessories specified for this model to prevent faults, short circuits or electric shock.
- Do not attempt to remove parts of the housing (covers) yourself. Repairs must be done at authorized service centers only.
- Protect the camera against contact with insect sprays and other aggressive chemicals. Petroleum spirit, thinner and alcohol must not be used for cleaning. Some chemicals and liquids can damage the camera housing or the surface finish.
- Rubber and plastics are known to expel aggressive chemicals and should therefore not be kept in contact with the camera for extended periods of time.
- Prevent any sand or dust or water penetration into the camera, e.g. during snowfall or rain or on the beach. Be extra careful when changing the lens (in system cameras) and when inserting or removing the film pack. Sand and dust can damage the camera and lenses. Moisture can cause malfunctions and irreparable damage.

LENS

- A camera lens can have the effect of a magnifying glass when exposed to direct frontal sunlight. The camera must therefore be protected against extended exposure to direct sunlight.
- Attaching the lens cap and keeping the camera in the shade or ideally in its camera case, will help prevent damage to the interior of the camera.

CARRY STRAP

- Once you have attached the carry strap, please make sure that the clips are mounted correctly to prevent the camera from falling.
- Carry straps are usually made of very robust material. You should therefore keep it out of the reach of children. A carry strap is not a toy and poses a strangulation risk.
- Use the carry strap only for its intended purpose on a camera or on binoculars. Any other use poses the risk of injury and may possibly result in damage to the carry strap and is therefore not permitted.
- Carry straps should also not be used for cameras/binoculars during sports activities that pose a risk of entanglement (e.g. when mountain climbing and similar outdoor activities).

TRIPOD

- When using a tripod, make sure it is standing securely and turn the camera only by turning the tripod, not the actual camera.
- Ensure that the tripod screw is hand-tightened only.
- Avoid transporting the camera while the tripod is attached. You might injure yourself or others and the camera could get damaged.

FLASH

- The use of incompatible flash units with your Leica M6 may result in irreparable damage to the camera and/or the flash unit.